



Sanitary  
flow  
equipment

Quality System  
Certified ISO 9001



2WCL-2WK short elbow weld dimensions Rev.0.doc  
Page 1 of 1

## 2WK- 45° Short Welding Elbow Dimensions

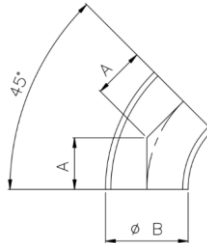

Dimensions and tolerance according to ASTM A270 - ASTM A269, compliant with ASME BPE-2002 table # DT-8

Ordering code	Size inch	B mm OD x Thk	A mm
2WK-A050..	1/2"	12,7 x 1,65	7,9
2WK-A075..	3/4"	19,05 x 1,65	11,9
2WK-A100..	1"	25,4 x 1,65	15,9
2WK-A150..	1 1/2"	38,1 x 1,65	23,8
2WK-A200..	2"	50,8 x 1,65	31,8
2WK-A250..	2 1/2"	63,5 x 1,65	39,7
2WK-A300..	3"	76,2 x 1,65	47,6
2WK-A400..	4"	101,6 x 2,11	63,5

## 2WCL- 90° Short Welding Elbow Dimensions

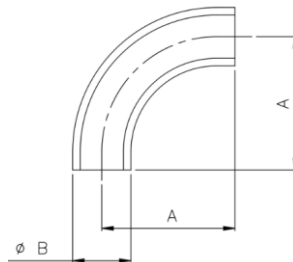

Dimensions and tolerance according to ASTM A270 - ASTM A269, compliant with ASME BPE-2002 table # DT-7

Ordering code	Size inch	B mm OD x Thk	A - mm
2WCL-A050..	1/2"	12,7 x 1,65	19,1
2WCL-A075..	3/4"	19,05 x 1,65	28,6
2WCL-A100..	1"	25,4 x 1,65	38,1
2WCL-A150..	1 1/2"	38,1 x 1,65	57,2
2WCL-A200..	2"	50,8 x 1,65	76,2
2WCL-A250..	2 1/2"	63,5 x 1,65	95,3
2WCL-A300..	3"	76,2 x 1,65	114,3
2WCL-A400..	4"	101,6 x 2,11	152,4

### Material:

ASTM A 479 / ASTM A 182 – 316L (wn. 1.4404)

### Surface finish:

Internal standard surface finish comply with ASME BPE Part SF Table # SF-4 surface designation code SFF2 with Ra average 0,5 micron or better, mechanically polished. External surface scotch brite

### Marking:

Each elbow are marked with material designation e.g. 316L SS  
3A and Heat No. for full lot traceability according to Aerrex Innox QA routines.

**Get the information you need and more at : [info@aerreinox.it](mailto:info@aerreinox.it)**

In the interests of development and improvement of the product, we reserve the right to change the specifications without prior notice.

**Aerrex Innox s.r.l.**

26010 FIESCO Via Gerola n.4 -CREMONA- Italy  
Tel. +39.0374.370828 Fax +39.0374.370833  
e-mail : [info@aerreinox.it](mailto:info@aerreinox.it) http : [www.aerreinox.it](http://www.aerreinox.it)